

# Hull Picture Light

CW1312, CW1322, CW1332 | 1.0

## VISUAL COMFORT & Co.

### STUDIO COLLECTION

#### GENERAL PRODUCT INFORMATION:

These fixtures are intended to be installed utilizing NEC compliant junction boxes.

This product is safety listed for damp locations.

Incandescent version may be dimmed with a standard incandescent dimmer. LED version may be dimmed with a LED dimmer. Consult lamp manufacturer for additional information.

This instruction shows a typical installation.

#### CAUTION - RISK OF FIRE

This product must be installed in accordance with the applicable installation code by a person familiar with the construction and operation of the product and the hazards involved.

Use minimum 90°C supply conductors.

#### SAVE THESE INSTRUCTIONS!

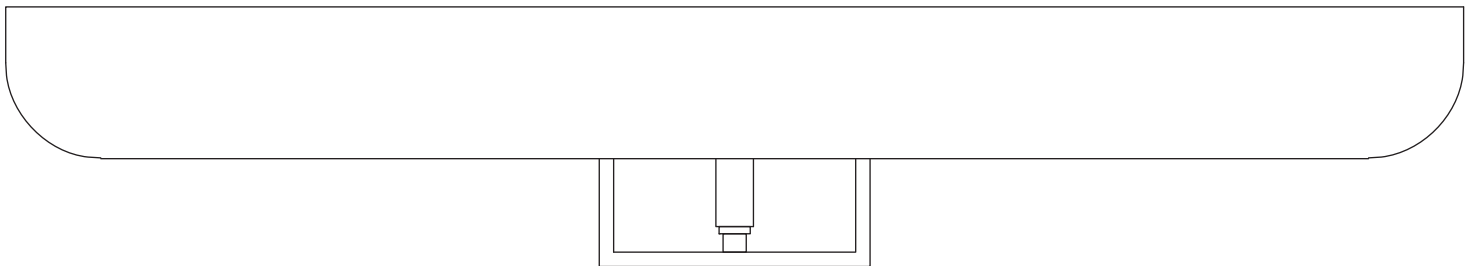
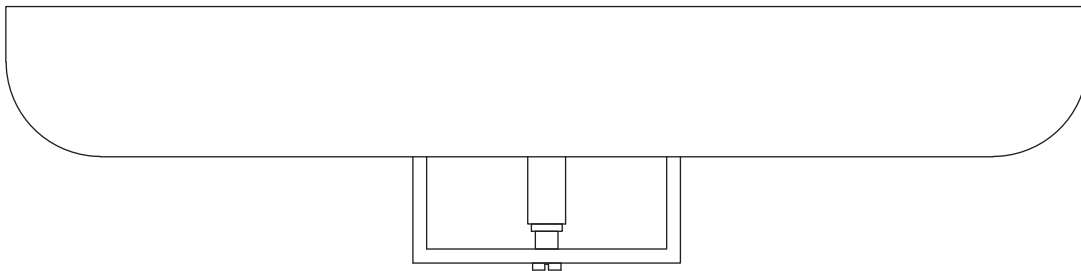
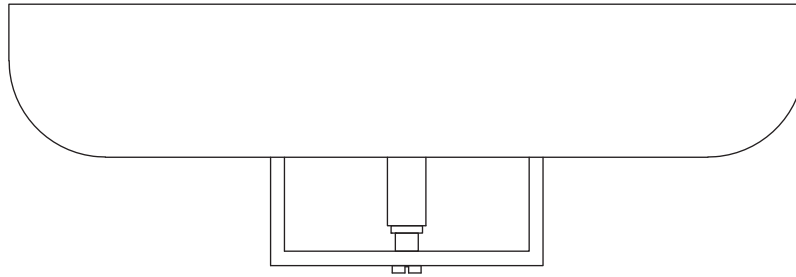

# Install the Fixture

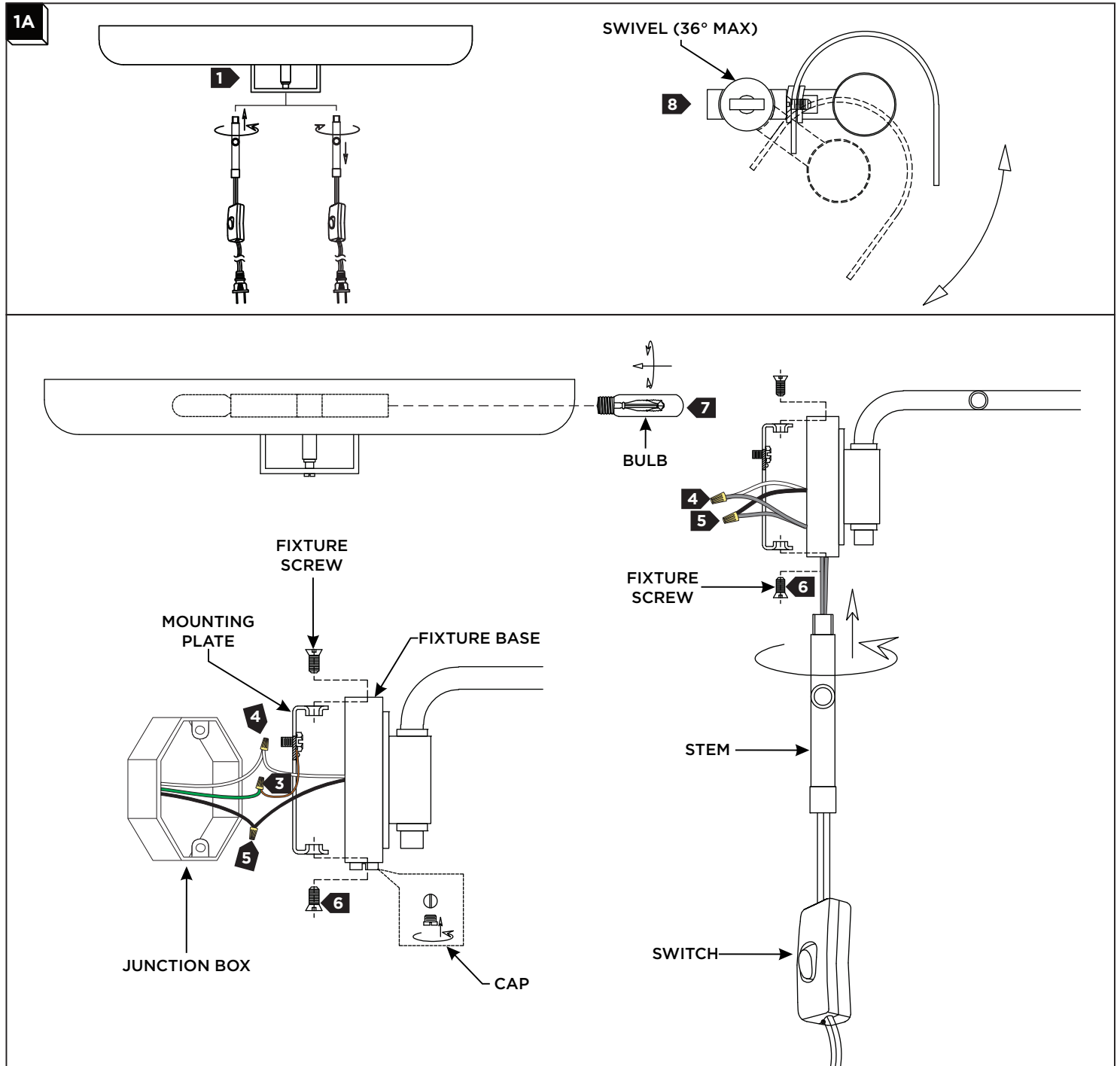

- 1** Determine the look of the fixture. For a the plug-in configuration, ensure the stem with the power cord is screwed into the bottom of the fixture base. For the J-box mounted configuration, ensure the stem is removed and the cap is screwed into the bottom of the fixture base.
- 2** Secure the mounting plate to the junction box/wall.
- 3 (J-box only)** Connect the fixture to a suitable ground in accordance to local electrical codes.
- 4** Connect the white fixture wire to the neutral power line wire with a wire nut.
- 5** Connect the black fixture wire to the hot power line wire with a wire nut.
- 6** Neatly place all the wires and wire nut connections into the junction box/fixture base, place the fixture base onto the mounting plate, and secure it in place by using the fixture screws.
- 7** Screw the lamp into the socket. Refer to the label on the socket for Max Wattage Information
- 8** Adjust the swivel to the desired angle (36 degrees Maximum).