

# Viaggio Linear Suspension

700LSVGO

1.1

VISUAL COMFORT & Co.

MODERN COLLECTION

## GENERAL PRODUCT INFORMATION:

These fixtures are intended to be installed utilizing NEC compliant junction boxes.



Incandescent version may be dimmed with a standard incandescent dimmer. LED version may be dimmed with a LED dimmer. Consult lamp manufacturer for additional information.

This product is suitable for damp locations.

This instruction shows a typical installation.

### CAUTION - RISK OF FIRE

This product must be installed in accordance with the applicable installation code by a person familiar with the construction and operation of the product and the hazards involved.

Use minimum 90°C supply conductors.

Two Person Installation Recommended

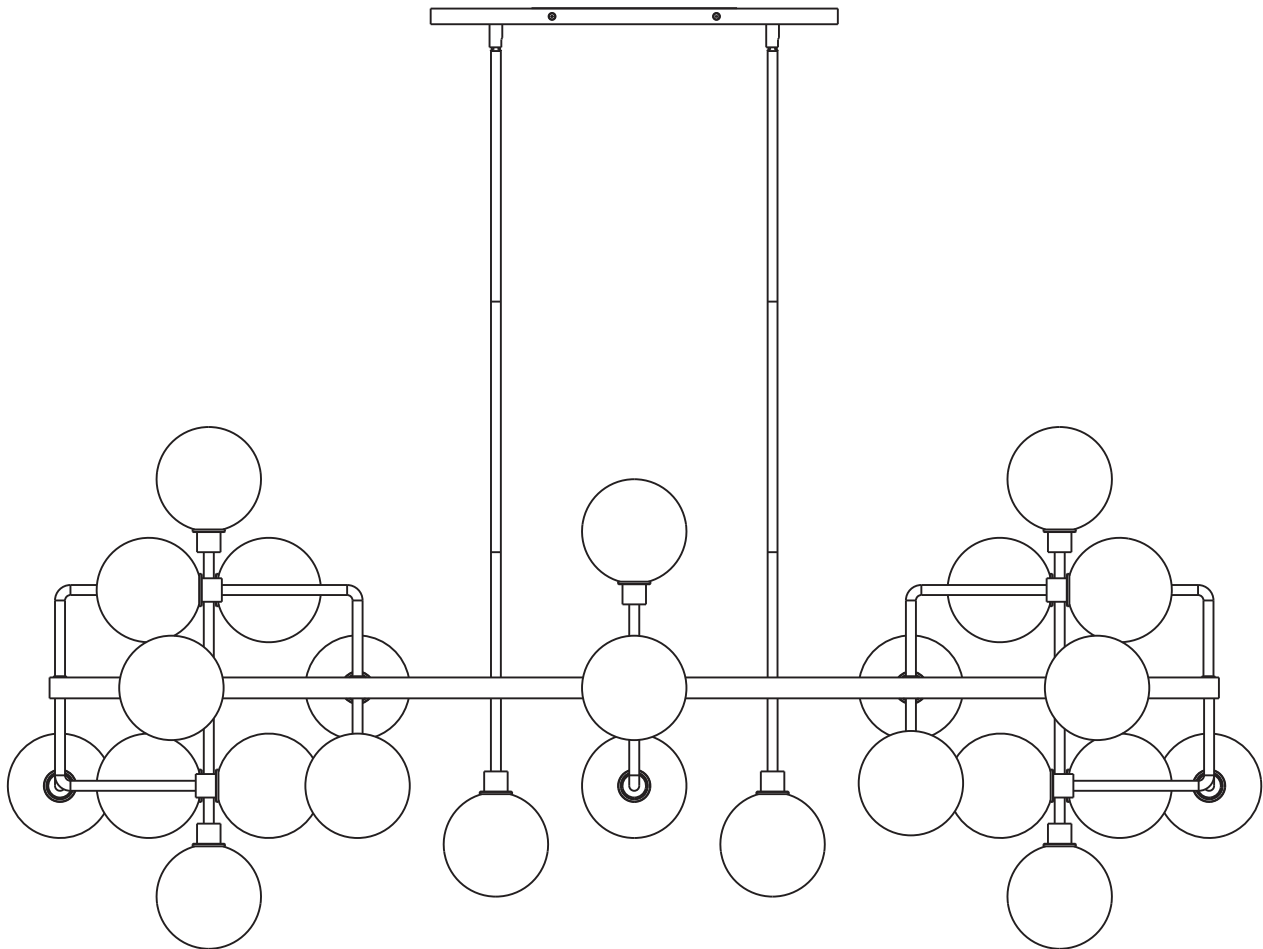

VISUAL COMFORT & Co.

7400 Linder Ave, Skokie, IL 160077

800.969.3347

[www.visualcomfort.com](http://www.visualcomfort.com)

©2023 Visual Comfort & Co.. All rights reserved. The Visual Comfort & Co. logo is a registered trademark of Visual Comfort & Co. Visual Comfort & Co. reserves the right to change specifications for product improvements without notification

**SAVE THESE INSTRUCTIONS!**

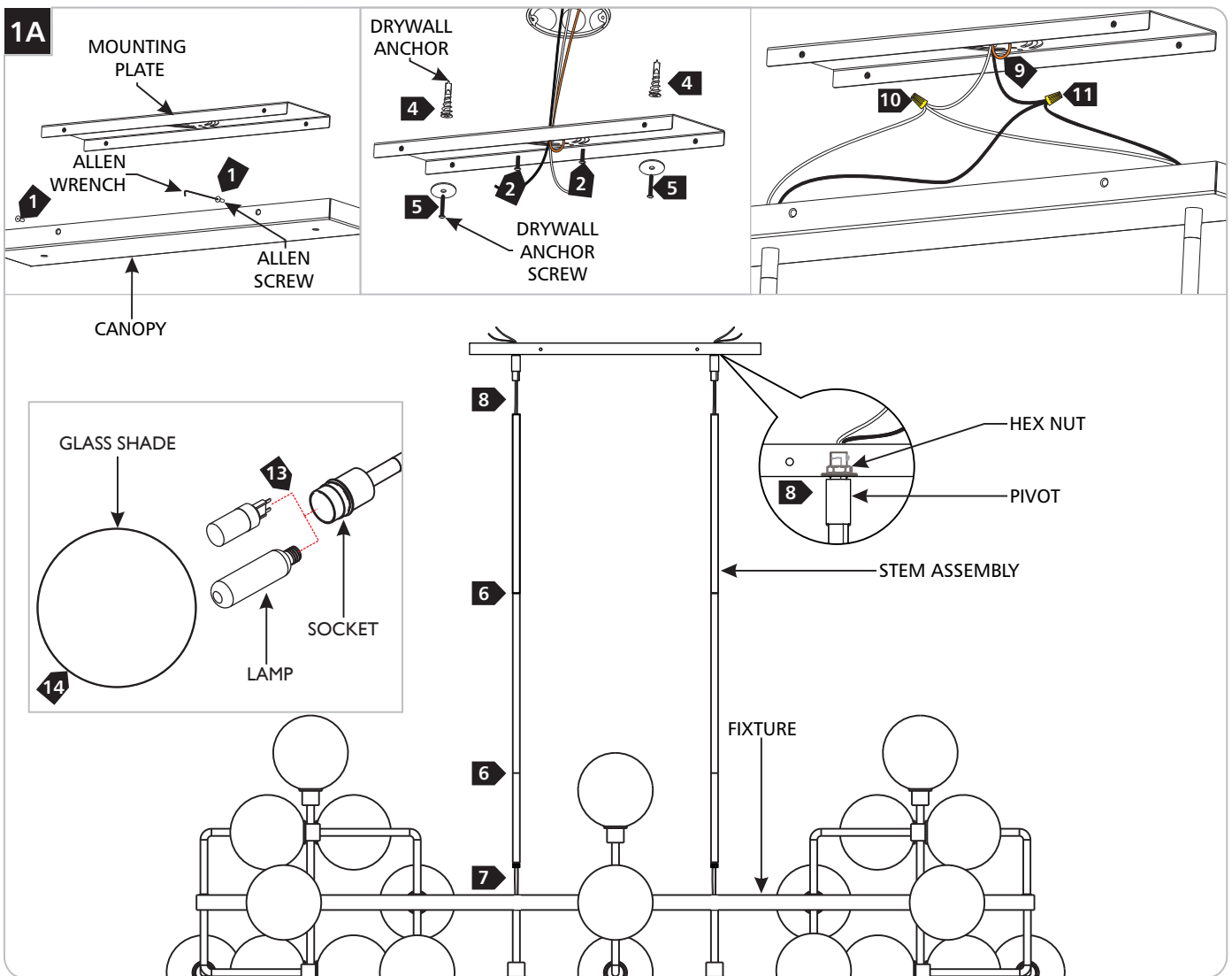

**CAUTION:** To reduce the risk of a burn or electric shock during re-lamping, disconnect the power to the fixture.

- 1 Remove the Allen screws on the sides of the canopy using the provided Allen wrench, then remove the mounting plate from the canopy.
- 2 Temporarily install the mounting plate onto the electrical box with the two #8-32 screws provided.
- 3 Mark the location of the drywall anchors. Then remove the mounting plate.
- 4 Tap the drywall anchors into the drywall at the marked locations.
- 5 Reinstall the mounting plate and screw the anchor screws into place using the provided screws and washers.
- 6 Assemble the stems to the desired height and feed the fixture wires through the stem assemblies. **CAUTION: Do not over-tighten the stems, as it may cause the stems to misalign.**
- 7 Screw the stem assemblies to the fixture.
- 8 Loosen the hex nuts on the pivots, then screw the stems to the pivots. If mounting to an angled ceiling, adjust both pivots so that they face the same direction in order to hang the fixture straight. **Note:** pivots accommodate up to a 45 degree ceiling. Re-tighten the hex nuts and tighten the set screws on the pivots to secure in place.
- 9 Connect the fixture to suitable ground in accordance with local electrical codes.
- 10 Connect the white fixture wires to the neutral power line wire with a wire nut.
- 11 Connect the black fixture wires to the hot power line wire with a wire nut.
- 12 Properly place all wires and wire nut connections into the canopy, mount the fixture back onto the mounting plate, and reinstall Allen screws (reversal of step 1).
- 13 Install the lamp according to fixture model. **For Bi-Pin lamps,** carefully insert the lamp pins into the holes on the socket. **For E12 lamps,** screw the lamp into the socket. Refer to the label on the socket for Max Wattage Information.
- 14 Install the glass shades by carefully screwing them onto the threads on the sockets. **Make sure the glass shade is installed correctly before releasing. Do not over-tighten.**