

# TRAVERSE DIRECT

## ROUND 6" DOWNLIGHT

The Traverse Direct is a sleek, low-profile LED Downlight designed for residential and commercial applications. Integrated, high-efficiency LEDs provide even, uniform illumination from edge to edge. This fixture provides a cost-effective solution for applications such as bathrooms, closets, hallways, and much more.

- 90 CRI, 850 Lumens while only requiring 13-Watts to power
- Complies with CEC 2019 Title 24 Part 6 (JA8-2016, JA8-2019)
- Dimmable. J-Box mounted; fixture may be mounted to wall or ceiling
- Wet-rated, approved for use in closet storage spaces per NEC Article 410.16
- High-efficiency LEDs; 50,000 life hours



ROUND 6", WHITE

### SPECIFICATIONS

DELIVERED LUMENS	800
WATTS	12
EFFICACY	65
CRI	90+
CCT	3000K
COLOR CONSISTENCY	3-step
INPUT VOLTAGE	120V
DIMMING <sup>1</sup>	5%
CONSTRUCTION	Housing: Polished aluminum   Trim: Polycarbonate
FINISH	White
GENERAL LISTINGS	CSA Listed. Wet-rated. Approved for use in closet storage spaces per NEC Article 410.16
WIRING	6.5" j-box mounted
CALIFORNIA TITLE 24	Registered CEC Appliance Database. Complies with CEC 2019 Title 24 Part 6 (JA8-2016, JA8-2019).
L70	50,000 hours min
WARRANTY <sup>2</sup>	5 years

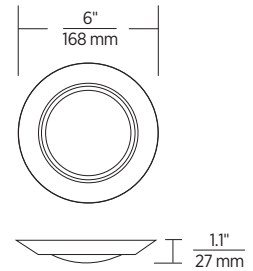

<sup>1</sup>See [visualcomfort.com](http://visualcomfort.com) for dimmer compatibility.

<sup>2</sup>Visit [visualcomfort.com](http://visualcomfort.com) for specific warranty limitations and details.

### ORDERING INFORMATION

#### FIXTURE

##### PRODUCT

14210S-15 TRAVERSE DIRECT, ROUND 6", WHITE

#### SHIPPING INFORMATION

PACKAGE TYPE	PRODUCT	QTY	UPC	LENGTH	WIDTH	HEIGHT	CUBE	WEIGHT	FREIGHT CLASS	UPS SHIP
INDIVIDUAL	14210S-15	1	785652130557	4"	4.1"	2.1"	0.02	0.6 LBS	45	YES
MASTER PACK		20	10785652130554	14.9"	13"	7.7"	0.863	12.5 LBS	12	YES
NJ PALLET		1620		48"	40"	77"	85.556	1500 LBS	729	NO
NV PALLET		1620		48"	40"	77"	85.556	1500 LBS	729	NO

# TRAVERSE DIRECT

ROUND 6" DOWNLIGHT

## PROJECT INFORMATION

---

## JOB NAME AND INFORMATION

---

---

---

---

---

---

---

---

---

---

## FIXTURE TYPE AND QUANTITY

---

---

---

---

---

---

---

---

---

---

## NOTES

---

---

---

---

---

---

---

---

---

---

---

---

---

---

---

---

---

---

---

---

---

---

---

---