

TRAVERSE AUBREY WALL WASH

ROUND 5" DOWNLIGHT

The Traverse Aubrey Wall Wash is a sleek, low-profile LED Downlight designed for residential and commercial applications. Integrated, high-efficiency LEDs provide even, uniform illumination from edge to edge. This fixture provides a cost-effective solution for applications such as bathrooms, closets, hallways, and much more.

- Uniform vertical and horizontal illumination on wall
- 90 CRI, 580 Lumens while only requiring 10-Watts to power
- Dimmable; J-Box mounted
- Wet-rated
- High-efficiency LEDs; 50,000 life hours



ROUND 5", WHITE

SPECIFICATIONS

DELIVERED LUMENS	580
WATTS	10
EFFICACY	57
CRI	90+
CCT	3000K
COLOR CONSISTENCY	3-step
INPUT VOLTAGE	120V
DIMMING ¹	5%
CONSTRUCTION	Housing: Polycarbonate Trim: Frosted acrylic
FINISH	White
GENERAL LISTINGS	ETL Listed. Wet-rated.
WIRING	6.5" j-box mounted
L70	50,000 hours min
WARRANTY ²	5 years

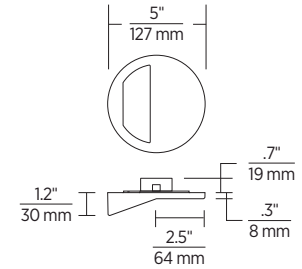

¹See visualcomfort.com for dimmer compatibility.

²Visit visualcomfort.com for specific warranty limitations and details.

ORDERING INFORMATION

FIXTURE

PRODUCT

14936RD-15 TRAVERSE AUBREY WALL WASH, ROUND 5", WHITE

SHIPPING INFORMATION

PACKAGE TYPE	PRODUCT	QTY	UPC	LENGTH	WIDTH	HEIGHT	CUBE	WEIGHT	FREIGHT CLASS	UPS SHIP
INDIVIDUAL	14936RD-15	1	785652073151	5.5"	5.25"	2.75"	0.046	.7 LBS	70	YES
MASTER PACK	14936RD-15	6	10785652073158	11.5"	8"	6.5"	1.346	4.6 LBS	70	YES
NJ PALLET		1200		48"	40"	76.5"	85	1012 LBS		NO
NV PALLET		1200		48"	40"	76.5"	85	1012 LBS		NO

TRAVERSE AUBREY WALL WASH

ROUND 5" DOWNLIGHT

PROJECT INFORMATION

JOB NAME AND INFORMATION

FIXTURE TYPE AND QUANTITY

NOTES

VISUAL COMFORT & Co.

ARCHITECTURAL COLLECTION

7400 Linder Avenue, Skokie, Illinois 60077

T 847.410.4400

visualcomfort.com

