

Power Extender

700MOP_ 2.1



GENERAL PRODUCT INFORMATION:

This product is suitable for indoor dry locations only.

This product is intended for use with Tech Lighting MonoRail system only.



CAUTION - RISK OF FIRE
 This product must be installed in accordance with the applicable installation code by a person familiar with the construction and operation of the product and the hazards involved.
Use minimum 90°C supply conductors.

SAVE THESE INSTRUCTIONS!

Resizing the Power Extenders for Surface Transformers

NOTE: The power extenders are precut for MonoRail power feed canopies. Power extenders must be cut to size when used with surface transformers. Refer to the chart below for measurements.

NOTE: Before completing the assembly of the transformer, refer to this instruction to modify the transformer for the Power Extender installation. Then complete assembly according to transformer instructions.

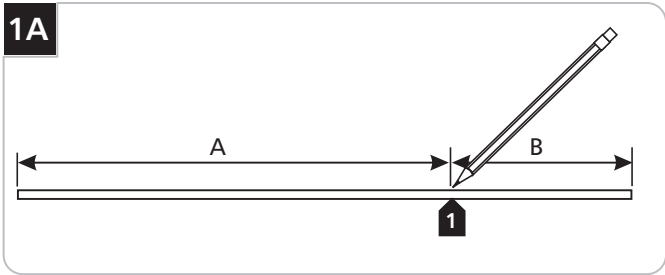

1 From one end mark the section of the extender that needs to be shortened (B), refer to the chart below for measurements.



2 Cut the marked sections with a hacksaw.

3 Clean the inside and outside burrs of the cut section.

NOTE: The column to the left identifies the transformer by the shortest compatible rigid standoff. This information is referred to in the spec sheet for each particular transformer which may be found either in the TECH LIGHTING catalog or at www.techlighting.com.

Shortest Compatible Rigid Standoff	Extender Rod Length for 3" Overall (A)	Extender Rod Length for 6" Overall (A)	Extender Rod Length for 12" Overall (A)	Extender Rod Length for 24" Overall (A)	Extender Rod Length for 36" Overall (A)	Extender Rod Length for 48" Overall (A)	Extender Rod Length for 96" Overall (A)
2"	1-7/8"	4-1/4"	10-1/4"	22-1/4"	34-1/4"	46-1/4"	94-1/4"
3"	N/A	2-3/8"	8-3/8"	20-3/8"	32-3/8"	44-3/8"	92-3/8"
4"	N/A	1-1/4"	7-1/4"	19-1/4"	31-1/4"	43-1/4"	91-1/4"
5"	N/A	N/A	6-1/4"	18-1/4"	30-1/4"	42-1/4"	90-1/4"

Installing the Power Extender (Standard Transformer/Canopy)

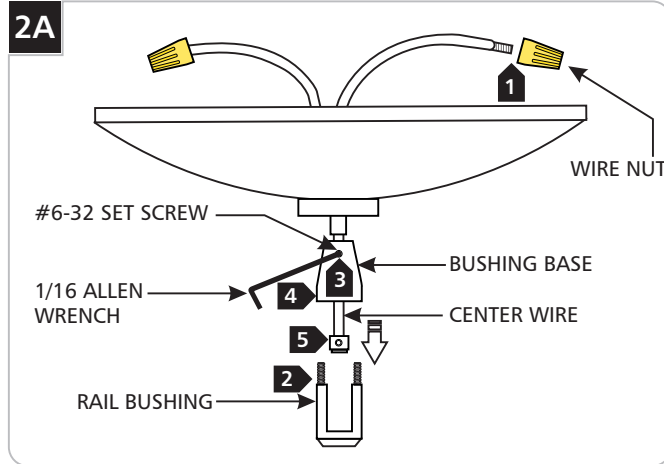

- 1** Remove the wire nut from the center wire.
- 2** Unscrew and remove the rail bushing from the bushing base.
- 3** Loosen (**do not remove**) the #6-32 set screw on the bushing base with the 1/16 Allen wrench.
- 4** Pull the bushing base with the center wire out of the canopy.

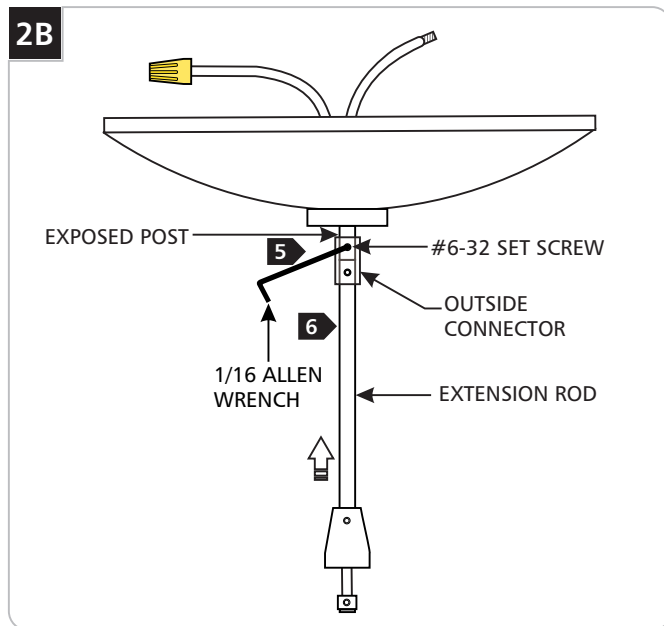

- 5** Place the outside connector half way onto the exposed post and tighten the #6-32 set screw with the 1/16 Allen wrench.
- 6** Push the extension rod completely into the outside connector while feeding the new center wire through the transformer.

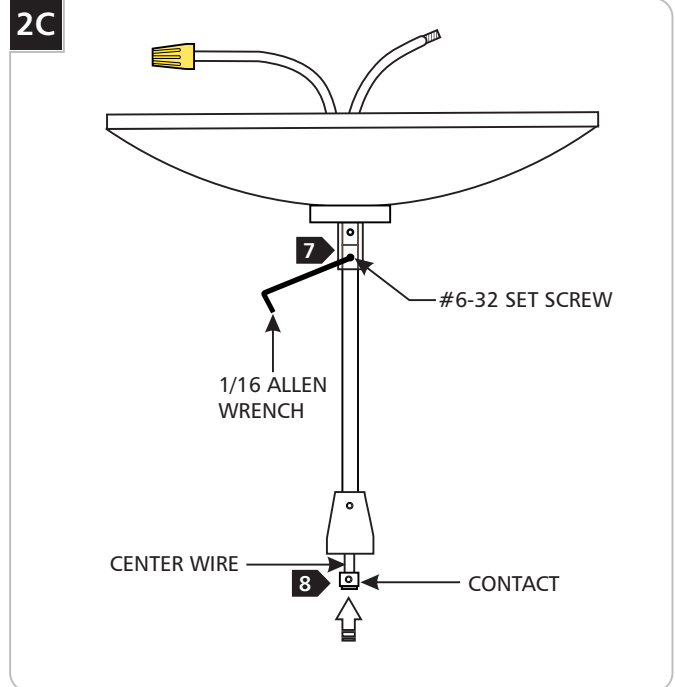

- 7** Tighten the bottom #6-32 set screw with the 1/6 Allen wrench to secure the extension rod.
- 8** Make sure that the center wire is completely pushed inside the housing nipple so that the contact sits against the housing nipple.
- 9** Follow the instructions provided with the power feed canopy to complete the installation.

Installing the Power Extender (Mini Surface Transformer)

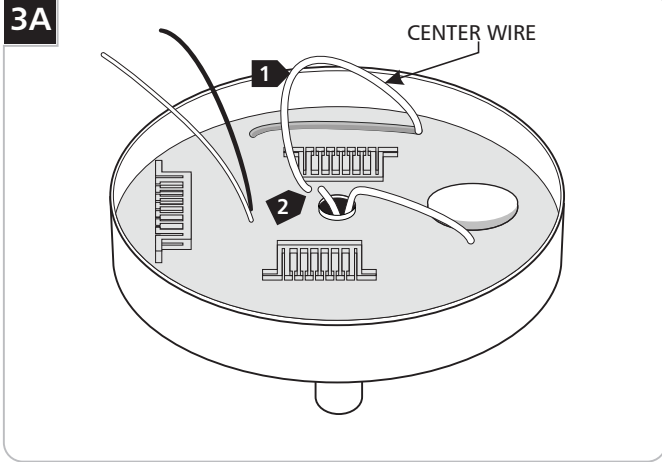

- 1 Pull up the wire that leads through the center of the power feed. If the wire is embedded in the potting it is okay to pull the wire out of the potting material.
- 2 Cut the center wire as close to the power feed as possible.

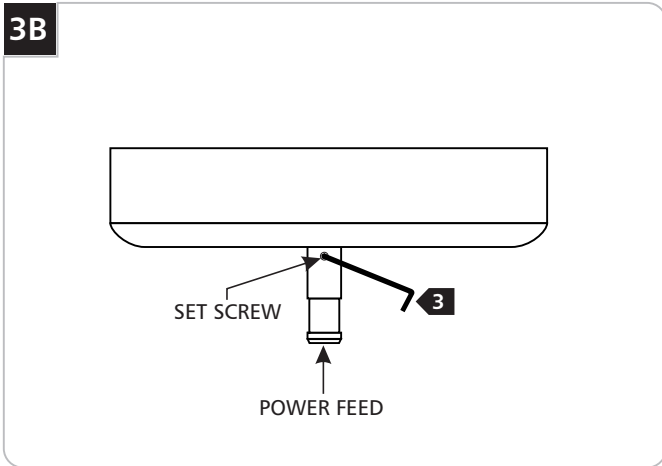

- 3 Loosen the set screw on the power feed.

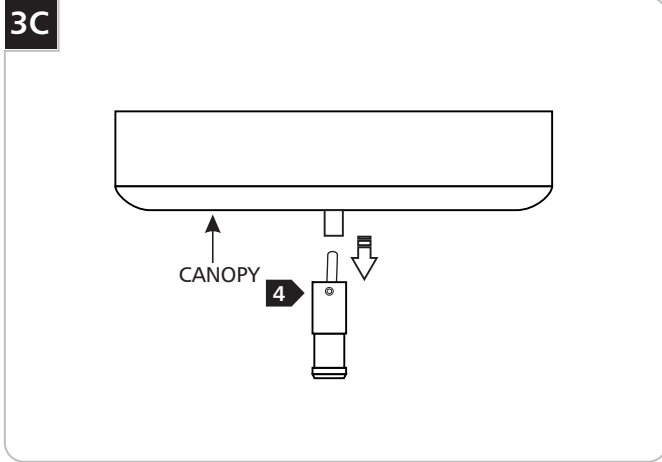

- 4 pull the power feed and wire from the canopy.

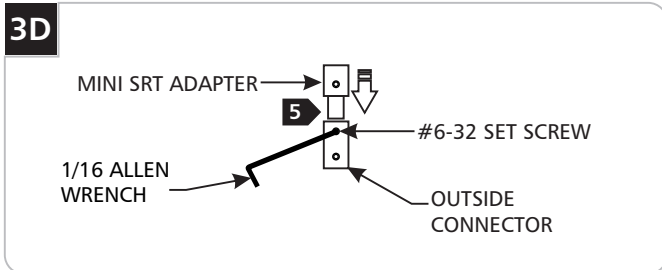

- 5 Install the Mini SRT adapter onto one end of the outside connector and tighten the #6-32 set screw with the 1/16 Allen wrench.

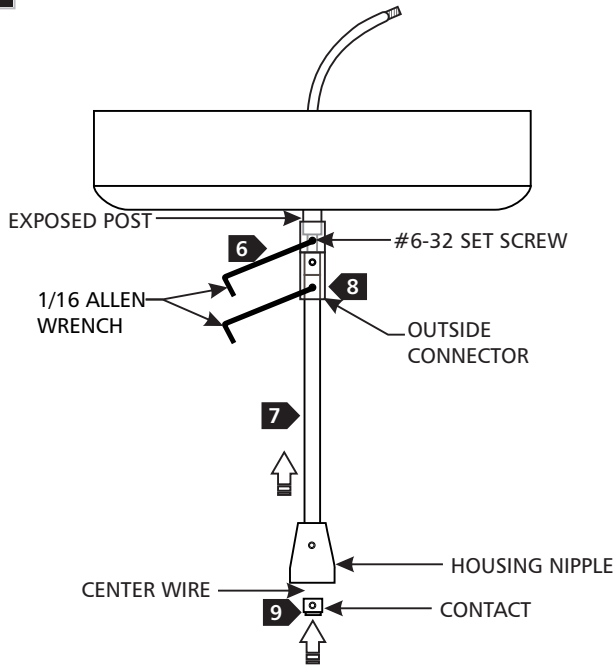
3E

- 6** Place the outside connector half way onto the exposed post and tighten the #6-32 set screw with the 1/16 Allen wrench.
- 7** Push the extension rod completely into the outside connector while feeding the new center wire through the transformer.
- 8** Tighten the bottom #6-32 set screw with the 1/16 Allen wrench to secure the extension rod.
- 9** Make sure that the center wire is completely pushed inside the housing nipple so that the contact sits against the housing nipple.

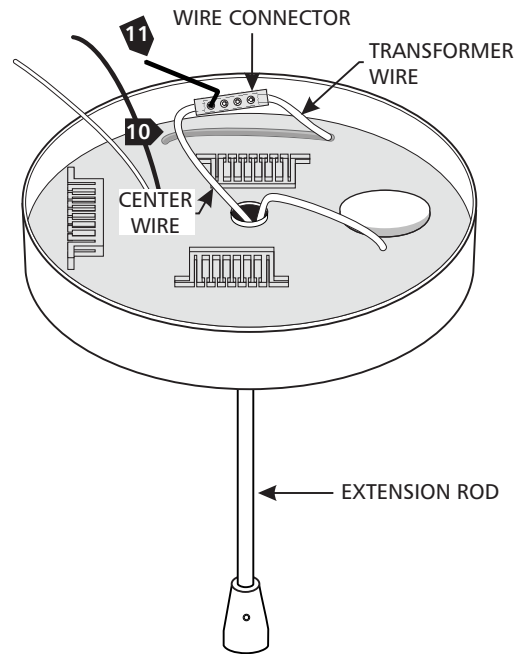
3F

- 10** Strip the end of the transformer wire.
- 11** Loosen (**Do Not Remove**) the four set screws in the wire connector.
- 12** Push the transformer wire half way into the wire connector and tighten down the two set screws on that side.
- 13** Push the center wire into the other half and tighten down the remaining two set screws.
- 14** Follow the instructions provided with the mini surface transformer to complete the installation.

NOTE: When installing the transformer onto the mounting plate it may be necessary to push the wire nut through the center of the mounting plate into to the junction box due to space limitations inside the canopy.

 **TECH LIGHTING**

7400 Linder Ave., Skokie, IL 60077
 T 847.410.4400 | F 847.410.4500
www.techlighting.com